



VACUSERA

PRODUCT CATALOGUE

disera
RESULTS OF THE SCIENTIFIC PROCESS



INDEX

About Us	4
Production	5
VACUSERA Blood Collection Systems	6
VACUSERA Blood Collection System Components and Labeling Symbols	7
VACUSERA Blood Collection Steps	8
VACUSERA Blood Collection Tubes	9
VACUSERA Serum Clot Activator Tubes	10
VACUSERA Serum Gel & Clot Activator and Thrombin Based Serum Gel Tubes	11
VACUSERA K2EDTA Tubes	12
VACUSERA K3EDTA and K3Edta + Aprotinin Tubes	13
VACUSERA Coagulation Tubes	14
VACUSERA CTAD Tubes	15
VACUSERA Lithium Heparin Tubes	16
VACUSERA Sodium Heparin Tubes	17
VACUSERA No Additive Tubes	18
VACUSERA ACD-A & ACD-B Tubes	19
VACUSERA Trace Element Tubes	20
VACUSERA Crossmatch Tubes	21
VACUSERA Glucose Tubes	22-23
VACUSERA Blood Collection Needles	24-25
VACUSERA Blood Collection Accessories	26-29
VACUSERA Mini Capillary Blood Collection System	30-31
VACUSERA Sedimentation Systems	32
VACUSERA Urine Collection Systems	33
VACUSERA Blood Collection Systems Order Of Draw	34



ABOUT US

Disera was founded in 1996 in Izmir, Turkey, initially focusing on the production of laboratory consumables. Today, Disera is one of the leading international companies in the industry, specializing in the production and development of blood collection tubes, blood collection accessories, urine collection systems, and PRP products. Additionally, Disera is active in the laboratory diagnostics sector within its domestic market.

For us as a company, patient comfort and the safety of healthcare workers come first. Our core value proposition with our products and services is to improve the overall standard of living and health of communities worldwide.

Quality has remained a top priority since the foundation of our company, and all our production sites are committed to the same high standard. All products have the CE mark, and the entire production operation is carried out in accordance with ISO 13485:2016 Quality Management Systems, ISO 14001:2015 Environmental Management Systems and Good Manufacturing Practice (GMP) certificate.

We are dedicated to continuous innovation and research. Additionally, our corporate social responsibility initiatives contribute to the community, enhancing our role as a socially responsible organization.

OUR MISSION

Our mission is to design and manufacture environmentally sustainable, safe and high-quality medical products that comply with all relevant regulations. We are committed to prioritizing customer satisfaction through a customer-oriented approach and engaging with communities and stakeholders to address their needs.

By integrating innovative technologies and continuous research into our product design and production processes, we strive to enhance the quality of life and improve community health standards. Additionally, we are committed to the well-being and development of our employees and to adhering to ethical business practices.

OUR VISION

Our vision is to become one of the leading companies in the healthcare sector, adding significant value to healthcare services worldwide. We embrace innovation and a culture of excellence.

By producing high-quality products, we aim to enhance patient quality of life and ensure healthcare professionals can confidently use our products. We prioritize sustainability principles to ensure a safer world for future generations and emphasize the importance of collaborations and partnerships to advance healthcare standards.

RESEARCH and DEVELOPMENT

Tracking innovations continuously and offering the most suitable products for customers.



PRODUCTION

Disera Tıbbi Malzeme Lojistik Sanayi ve Ticaret A.Ş having the knowledge and experience on providing quality and technical products in the medical sector, combined with the needs of the healthcare industry innovative product solutions and offers production activities according to the ISO 13485:2016 quality standards.

Vacusera Blood Collection Tubes are CE marked according to the 98/79/EC IVD and 2017/746 IVDR directive and produce ISO 6710.

Vacusera Blood Collection Needles and Accessories are CE certified and manufactured according to the 2017/745 MDR directive.

Consistent with a constantly updated technology infrastructure and experienced staff, and also the production quality assurance norms are shaped by different national and international guidelines provide the high quality level of products of Disera.

VACUSERA BLOOD COLLECTION SYSTEMS

In an increased automation environment in the diagnostic laboratory field and higher standards require a continuous performance of the blood collection systems. Vacusera Blood Collection Tubes, Vacusera Blood Collection Needles and Accessories are designed according to fulfill the requirements of blood collection procedures, patient's comfort and user's safety.



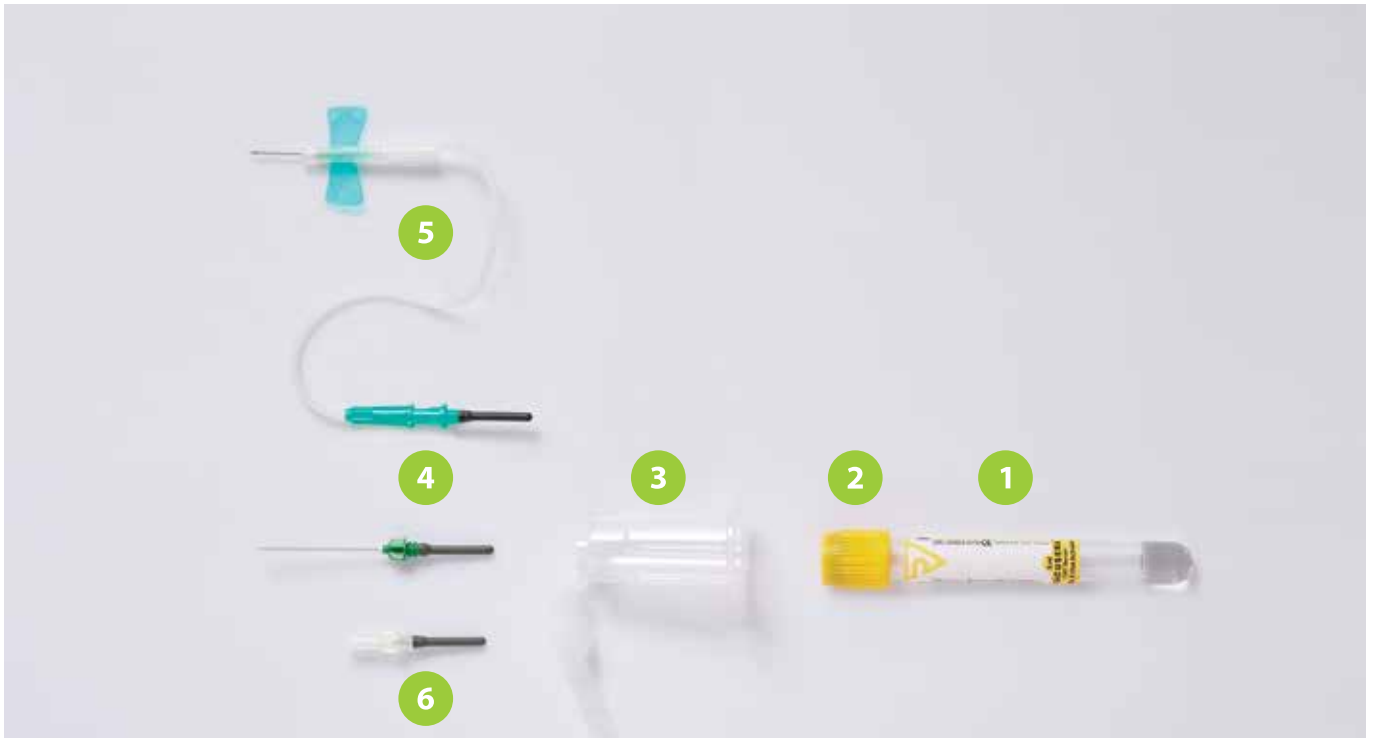

NUMBER	VACUSERA BLOOD COLLECTION COMPONENTS	LETTER CODE	ADDITIVE
1	Vacusera Blood Collection Tube	K2E	EDTA Dipotassium Salt
2	Safety Cap	K3E	EDTA Tripotassium Salt
3	Tube Holder with Safety Shield	9NC	Trisodium Citrate 9:1
4	Vacusera Blood Collection Needle	4NC	Trisodium Citrate 4:1
5	Vacusera Safety Blood Collection Set with Safety Shield	FE	Sodium Fluoride / EDTA
6	Vacusera Luer Adapter	FX	Sodium Fluoride/Potassium Oxalate
		LH	Lithium Heparin
		NH	Sodium Heparin
		Z	None
		CAT	Clot Activator / Clot Activator with Gel
		CTAD	Buffered Citrate 0.109 M
		ACD-A	ACD-A Solution A
		ACD-B	ACD-B Solution B
		FC	Fluoride, Citric Acid

VACUSERA BLOOD COLLECTION SYSTEM LABELLING SYMBOLS

- Do Not Reuse
- Use By-Date
- Batch Code
- Reference Number
- Date of Manufacture
- Manufacturer
- Keep away from sunlight
- Do not use if package is damaged
- Keep Dry
- Non-pyrogenic
- Phthalate Free
- Unique Device Identification

- Sterilized Using Ethylene oxide
- Sterilized Using Irradiation
- CE Mark
- CE Marking (with notified body number)
- In Vitro Diagnostic Medical Device
- Consult Instructions for Use
- Temperature Limit
- Latex free
- Do not Resterilize
- Caution
- Non-Sterile
- Medical Device
- Single Sterile Barrier System

BLOOD COLLECTION STEPS

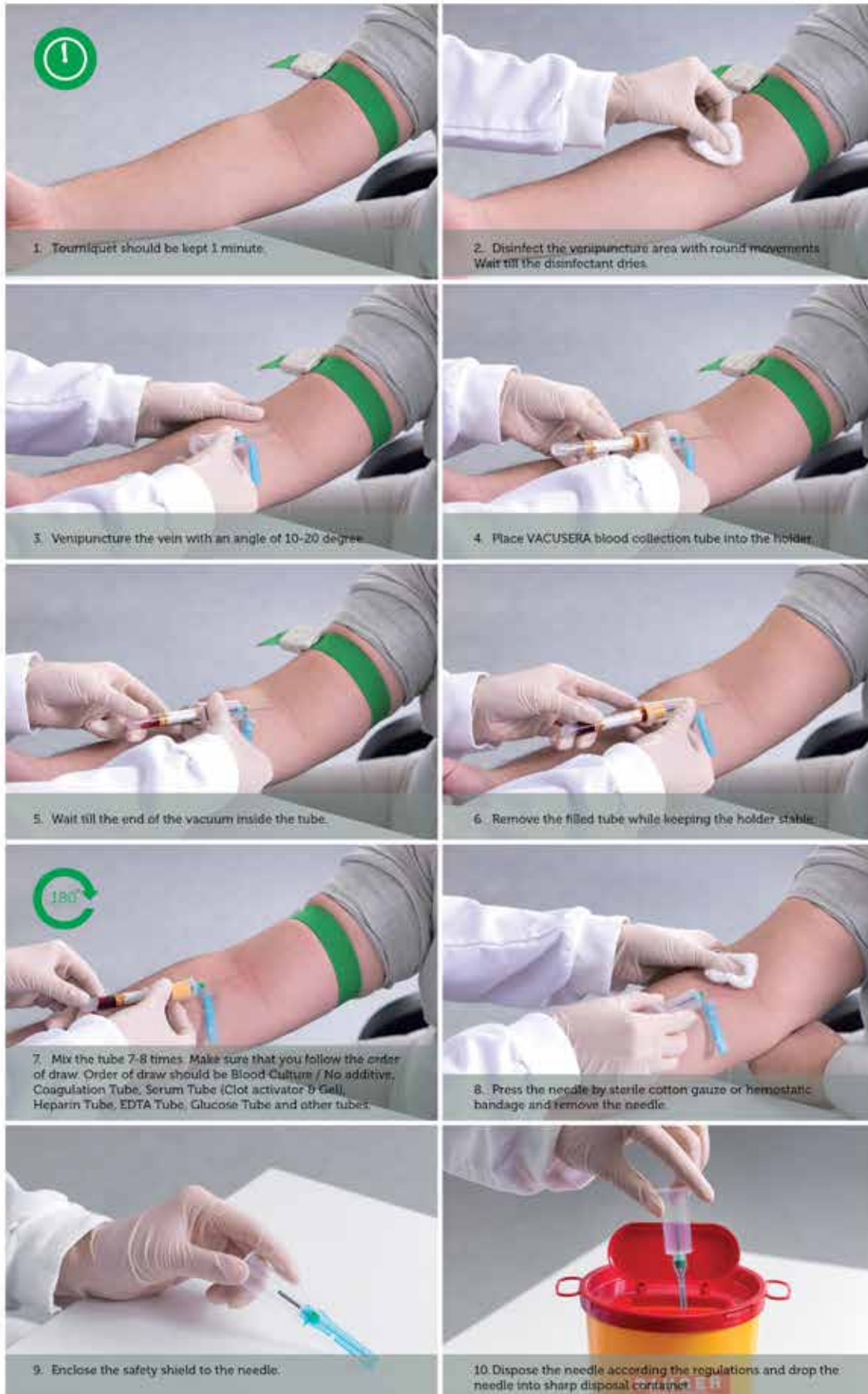



VACUSERA BLOOD COLLECTION TUBES

Vacusera Blood Collection Tubes are made of unbreakable PET tube, butyl rubber stopper and polyethylene cap. We offer medical paper labeled tubes, transparent labeled tubes and also pre-barcoded tubes. All components of Vacusera Blood Collection Systems improve patient's comfort, help safe and quality blood collection and also reliable test results.

PAPER LABELED TUBES



TRANSPARENT LABELED TUBES



PRE-BARCODED TUBES





VACUSERA SERUM CLOT ACTIVATOR TUBES

Vacusera Serum Clot Activator Tubes are used for clinical biochemistry and immunology. The inner wall of the Serum Clot Activator Tube is specially coated with clot activator, which activate coagulation process.

Reference Number	Description	Draw vol. (ml)	Size (mm)	Additive	Shelf life	Label Type	Pack/Carton	Cap Colour
234201	VACUSERA 1 ml CAT Serum Clot Activator	1	13 x 75	Clot Activator	18 months	Paper	100/1200	●
234202	VACUSERA 2 ml CAT Serum Clot Activator	2	13 x 75	Clot Activator	18 months	Paper	100/1200	●
234203	VACUSERA 3 ml CAT Serum Clot Activator	3	13 x 75	Clot Activator	18 months	Paper	100/1200	●
234204	VACUSERA 4 ml CAT Serum Clot Activator	4	13 x 75	Clot Activator	18 months	Paper	100/1200	●
235206	VACUSERA 6 ml CAT Serum Clot Activator	6	13 x 100	Clot Activator	18 months	Paper	100/1200	●
236209	VACUSERA 9 ml CAT Serum Clot Activator	9	16 x 100	Clot Activator	18 months	Paper	100/1200	●
236200	VACUSERA 10 ml CAT Serum Clot Activator	10	16 x 100	Clot Activator	18 months	Paper	100/1200	●
434201	VACUSERA 1 ml CAT Serum Clot Activator	1	13 x 75	Clot Activator	18 months	Transparent	100/1200	●
434202	VACUSERA 2 ml CAT Serum Clot Activator	2	13 x 75	Clot Activator	18 months	Transparent	100/1200	●
434203	VACUSERA 3 ml CAT Serum Clot Activator	3	13 x 75	Clot Activator	18 months	Transparent	100/1200	●
434204	VACUSERA 4 ml CAT Serum Clot Activator	4	13 x 75	Clot Activator	18 months	Transparent	100/1200	●
435206	VACUSERA 6 ml CAT Serum Clot Activator	6	13 x 100	Clot Activator	18 months	Transparent	100/1200	●
436209	VACUSERA 9 ml CAT Serum Clot Activator	9	16 x 100	Clot Activator	18 months	Transparent	100/1200	●
436200	VACUSERA 10 ml CAT Serum Clot Activator	10	16 x 100	Clot Activator	18 months	Transparent	100/1200	●



VACUSERA SERUM GEL AND CLOT ACTIVATOR TUBES

Vacusera Serum Separator Tubes contain inert gel; during centrifugation, gel forms a stable barrier between serum and blood cells.

Reference Number	Description	Draw vol. (ml)	Size (mm)	Additive	Shelf life	Label Type	Pack/Carton	Cap Colour
234302	VACUSERA 2 ml CAT Serum GEL and Clot Activator	2	13 x 75	GEL + Clot Activator	18 months	Paper	100/1200	●
234304	VACUSERA 2.5 ml CAT Serum GEL and Clot Activator	2.5	13 x 75	GEL + Clot Activator	18 months	Paper	100/1200	●
234303	VACUSERA 3.5 ml CAT Serum GEL and Clot Activator	3.5	13 x 75	GEL + Clot Activator	18 months	Paper	100/1200	●
235304	VACUSERA 4 ml CAT Serum GEL and Clot Activator	4	13 x 100	GEL + Clot Activator	18 months	Paper	100/1200	●
235305	VACUSERA 5 ml CAT Serum GEL and Clot Activator	5	13 x 100	GEL + Clot Activator	18 months	Paper	100/1200	●
236308	VACUSERA 8 ml CAT Serum GEL and Clot Activator	8	16 x 100	GEL + Clot Activator	18 months	Paper	100/1200	●
236309	VACUSERA 9 ml CAT Serum GEL and Clot Activator	9	16 x 100	GEL + Clot Activator	18 months	Paper	100/1200	●
434302	VACUSERA 2 ml CAT Serum GEL and Clot Activator	2	13 x 75	GEL + Clot Activator	18 months	Transparent	100/1200	●
434304	VACUSERA 2.5 ml CAT Serum GEL and Clot Activator	2.5	13 x 75	GEL + Clot Activator	18 months	Transparent	100/1200	●
434303	VACUSERA 3.5 ml CAT Serum GEL and Clot Activator	3.5	13 x 75	GEL + Clot Activator	18 months	Transparent	100/1200	●
435304	VACUSERA 4 ml CAT Serum GEL and Clot Activator	4	13 x 100	GEL + Clot Activator	18 months	Transparent	100/1200	●
435305	VACUSERA 5 ml CAT Serum GEL and Clot Activator	5	13 x 100	GEL + Clot Activator	18 months	Transparent	100/1200	●
436308	VACUSERA 8 ml CAT Serum GEL and Clot Activator	8	16 x 100	GEL + Clot Activator	18 months	Transparent	100/1200	●
436309	VACUSERA 9 ml CAT Serum GEL and Clot Activator	9	16 x 100	GEL + Clot Activator	18 months	Transparent	100/1200	●

VACUSERA THROMBIN BASED SERUM GEL TUBES

Vacusera Thrombin based serum tubes provide rapid blood clotting by means of thrombin based clot activator and allow rapid serum separation together with the inert gel in the tubes.

Reference Number	Description	Draw vol. (ml)	Size (mm)	Additive	Shelf life	Label Type	Pack/Carton	Cap Colour
235315	VACUSERA 5 ml CAT Serum GEL and Thrombin	5	13 x 100	GEL + Clot Activator + Thrombin	12 months	Paper	100/1200	●
435315	VACUSERA 5 ml CAT Serum GEL and Thrombin	5	13 x 100	GEL + Clot Activator + Thrombin	12 months	Transparent	100/1200	●



VACUSERA K2EDTA TUBES

Vacusera K2EDTA Tubes are for examination of whole blood in hematology. K2EDTA and GEL is mainly used for molecular diagnostics.

Reference Number	Description	Draw vol. (ml)	Size (mm)	Additive	Shelf life	Label Type	Pack/Carton	Cap Colour
234601	VACUSERA 1 ml K2E/K2EDTA	1	13 x 75	K2E K2EDTA	18 months	Paper	100/1200	●
234602	VACUSERA 2 ml K2E/K2EDTA	2	13 x 75	K2E K2EDTA	18 months	Paper	100/1200	●
234603	VACUSERA 3 ml K2E/K2EDTA	3	13 x 75	K2E K2EDTA	18 months	Paper	100/1200	●
234604	VACUSERA 4 ml K2E/K2EDTA	4	13 x 75	K2E K2EDTA	18 months	Paper	100/1200	●
234605	VACUSERA 4.5 ml K2E/K2EDTA	4.5	13 x 75	K2E K2EDTA	18 months	Paper	100/1200	●
235606	VACUSERA 6 ml K2E/K2EDTA	6	13 x 100	K2E K2EDTA	18 months	Paper	100/1200	●
236609	VACUSERA 9 ml K2E/K2EDTA	9	16 x 100	K2E K2EDTA	18 months	Paper	100/1200	●
434601	VACUSERA 1 ml K2E/K2EDTA	1	13 x 75	K2E K2EDTA	18 months	Transparent	100/1200	●
434602	VACUSERA 2 ml K2E/K2EDTA	2	13 x 75	K2E K2EDTA	18 months	Transparent	100/1200	●
434603	VACUSERA 3 ml K2E/K2EDTA	3	13 x 75	K2E K2EDTA	18 months	Transparent	100/1200	●
434604	VACUSERA 4 ml K2E/K2EDTA	4	13 x 75	K2E K2EDTA	18 months	Transparent	100/1200	●
434605	VACUSERA 4.5 ml K2E/K2EDTA	4.5	13 x 75	K2E K2EDTA	18 months	Transparent	100/1200	●
435606	VACUSERA 6 ml K2E/K2EDTA	6	13 x 100	K2E K2EDTA	18 months	Transparent	100/1200	●
436609	VACUSERA 9 ml K2E/K2EDTA	9	16 x 100	K2E K2EDTA	18 months	Transparent	100/1200	●
234623	VACUSERA 3 ml K2E/K2EDTA + GEL	3	13 x 75	GEL + K2E K2EDTA	18 months	Paper	100/1200	●
235625	VACUSERA 5 ml K2E/K2EDTA + GEL	5	13 x 100	GEL + K2E K2EDTA	18 months	Paper	100/1200	●
236628	VACUSERA 8 ml K2E/K2EDTA + GEL	8	16 x 100	GEL + K2E K2EDTA	18 months	Paper	100/1200	●
434623	VACUSERA 3 ml K2E/K2EDTA + GEL	3	13 x 75	GEL + K2E K2EDTA	18 months	Transparent	100/1200	●
435625	VACUSERA 5 ml K2E/K2EDTA + GEL	5	13 x 100	GEL + K2E K2EDTA	18 months	Transparent	100/1200	●
436628	VACUSERA 8 ml K2E/K2EDTA + GEL	8	16 x 100	GEL + K2E K2EDTA	18 months	Transparent	100/1200	●



VACUSERA K3EDTA TUBES

Vacusera K3EDTA Tubes are for examination of whole blood in hematology.

Reference Number	Description	Draw vol. (ml)	Size (mm)	Additive	Shelf life	Label Type	Pack/Carton	Cap Colour
234611	VACUSERA 1 ml K3E/K3EDTA	1	13 x 75	K3E K3EDTA	18 months	Paper	100/1200	●
234612	VACUSERA 2 ml K3E/K3EDTA	2	13 x 75	K3E K3EDTA	18 months	Paper	100/1200	●
234613	VACUSERA 3 ml K3E/K3EDTA	3	13 x 75	K3E K3EDTA	18 months	Paper	100/1200	●
234614	VACUSERA 4 ml K3E/K3EDTA	4	13 x 75	K3E K3EDTA	18 months	Paper	100/1200	●
234615	VACUSERA 4.5 ml K3E/K3EDTA	4.5	13 x 75	K3E K3EDTA	18 months	Paper	100/1200	●
235616	VACUSERA 6 ml K3E/K3EDTA	6	13 x 100	K3E K3EDTA	18 months	Paper	100/1200	●
236619	VACUSERA 9 ml K3E/K3EDTA	9	16 x 100	K3E K3EDTA	18 months	Paper	100/1200	●
434611	VACUSERA 1 ml K3E/K3EDTA	1	13 x 75	K3E K3EDTA	18 months	Transparent	100/1200	●
434612	VACUSERA 2 ml K3E/K3EDTA	2	13 x 75	K3E K3EDTA	18 months	Transparent	100/1200	●
434613	VACUSERA 3 ml K3E/K3EDTA	3	13 x 75	K3E K3EDTA	18 months	Transparent	100/1200	●
434614	VACUSERA 4 ml K3E/K3EDTA	4	13 x 75	K3E K3EDTA	18 months	Transparent	100/1200	●
434615	VACUSERA 4.5 ml K3E/K3EDTA	4.5	13 x 75	K3E K3EDTA	18 months	Transparent	100/1200	●
435616	VACUSERA 6 ml K3E/K3EDTA	6	13 x 100	K3E K3EDTA	18 months	Transparent	100/1200	●
436619	VACUSERA 9 ml K3E/K3EDTA	9	16 x 100	K3E K3EDTA	18 months	Transparent	100/1200	●

VACUSERA K3E/K3EDTA + APROTININ TUBES

Vacusera K3EDTA + Aprotinin tubes allow us to work ACTH tests in room temperature.

Reference Number	Description	Draw vol. (ml)	Size (mm)	Additive	Shelf life	Label Type	Pack/Carton	Cap Colour
234654	VACUSERA 4 ml K3E/K3EDTA + Aprotinin	4	13 x 75	K3E/K3EDTA + Aprotinin	12 months	Paper	100/1200	●
235656	VACUSERA 6 ml K3E/K3EDTA + Aprotinin	6	13 x 100	K3E/K3EDTA + Aprotinin	12 months	Paper	100/1200	●
434654	VACUSERA 4 ml K3E/K3EDTA + Aprotinin	4	13 x 75	K3E/K3EDTA + Aprotinin	12 months	Transparent	100/1200	●
435656	VACUSERA 6 ml K3E/K3EDTA + Aprotinin	6	13 x 100	K3E/K3EDTA + Aprotinin	12 months	Transparent	100/1200	●



VACUSERA COAGULATION TUBES

Vacusera Coagulation Tubes are used for blood coagulation tests. Coagulation Tubes have a buffered sodium citrate solution of 0.109 mol/l (3.2%) or 0.129 mol/l (3.8 %). Double Tube (*DT) technology provides an excellent condition for coagulation tests.

VACUSERA 9NC COAGULATION SODIUM CITRATE 3.2%

Reference Number	Description	Draw vol. (ml)	Size (mm)	Additive	Shelf life	Label Type	Pack /Carton	Cap Colour
234501	VACUSERA 1 ml Coagulation 3.2% Sodium Citrate - DT	1	13 x 75	9NC Sodium Citrate 3.2%(0.109M)	9 months	Paper	100/1200	●
234502	VACUSERA 1.8 ml Coagulation 3.2% Sodium Citrate - DT	1.8	13 x 75	9NC Sodium Citrate 3.2%(0.109M)	9 months	Paper	100/1200	●
234503	VACUSERA 2.7 ml Coagulation 3.2% Sodium Citrate - DT	2.7	13 x 75	9NC Sodium Citrate 3.2%(0.109M)	9 months	Paper	100/1200	●
234504	VACUSERA 3.6 ml Coagulation 3.2% Sodium Citrate	3.6	13 x 75	9NC Sodium Citrate 3.2%(0.109M)	4 months	Paper	100/1200	●
234505	VACUSERA 4.5 ml Coagulation 3.2% Sodium Citrate	4.5	13 x 75	9NC Sodium Citrate 3.2%(0.109M)	4 months	Paper	100/1200	●
235505	VACUSERA 5 ml Coagulation 3.2% Sodium Citrate	5	13 x 100	9NC Sodium Citrate 3.2%(0.109M)	4 months	Paper	100/1200	●
434501	VACUSERA 1 ml Coagulation 3.2% Sodium Citrate - DT	1	13 x 75	9NC Sodium Citrate 3.2%(0.109M)	9 months	Transparent	100/1200	●
434502	VACUSERA 1.8 ml Coagulation 3.2% Sodium Citrate - DT	1.8	13 x 75	9NC Sodium Citrate 3.2%(0.109M)	9 months	Transparent	100/1200	●
434503	VACUSERA 2.7 ml Coagulation 3.2% Sodium Citrate - DT	2.7	13 x 75	9NC Sodium Citrate 3.2%(0.109M)	9 months	Transparent	100/1200	●
434504	VACUSERA 3.6 ml Coagulation 3.2% Sodium Citrate	3.6	13 x 75	9NC Sodium Citrate 3.2%(0.109M)	4 months	Transparent	100/1200	●
434505	VACUSERA 4.5 ml Coagulation 3.2% Sodium Citrate	4.5	13 x 75	9NC Sodium Citrate 3.2%(0.109M)	4 months	Transparent	100/1200	●
435505	VACUSERA 5 ml Coagulation 3.2% Sodium Citrate	5	13 x 100	9NC Sodium Citrate 3.2%(0.109M)	4 months	Transparent	100/1200	●

VACUSERA 9NC COAGULATION SODIUM CITRATE 3.8%

Reference Number	Description	Draw vol. (ml)	Size (mm)	Additive	Shelf life	Label Type	Pack /Carton	Cap Colour
234511	VACUSERA 1 ml Coagulation 3.8% Sodium Citrate - DT	1	13 x 75	9NC Sodium Citrate %3.8(0.129M)	9 months	Paper	100/1200	●
234512	VACUSERA 1.8 ml Coagulation 3.8% Sodium Citrate - DT	1.8	13 x 75	9NC Sodium Citrate %3.8(0.129M)	9 months	Paper	100/1200	●
234513	VACUSERA 2.7 ml Coagulation 3.8% Sodium Citrate - DT	2.7	13 x 75	9NC Sodium Citrate %3.8(0.129M)	9 months	Paper	100/1200	●
234514	VACUSERA 3.6 ml Coagulation 3.8% Sodium Citrate	3.6	13 x 75	9NC Sodium Citrate %3.8(0.129M)	4 months	Paper	100/1200	●
234515	VACUSERA 4.5 ml Coagulation 3.8% Sodium Citrate	4.5	13 x 75	9NC Sodium Citrate %3.8(0.129M)	4 months	Paper	100/1200	●
235515	VACUSERA 5 ml Coagulation 3.8% Sodium Citrate	5	13 x 100	9NC Sodium Citrate %3.8(0.129M)	4 months	Paper	100/1200	●
434511	VACUSERA 1 ml Coagulation 3.8% Sodium Citrate - DT	1	13 x 75	9NC Sodium Citrate %3.8(0.129M)	9 months	Transparent	100/1200	●
434512	VACUSERA 1.8 ml Coagulation 3.8% Sodium Citrate - DT	1.8	13 x 75	9NC Sodium Citrate %3.8(0.129M)	9 months	Transparent	100/1200	●
434513	VACUSERA 2.7 ml Coagulation 3.8% Sodium Citrate - DT	2.7	13 x 75	9NC Sodium Citrate %3.8(0.129M)	9 months	Transparent	100/1200	●
434514	VACUSERA 3.6 ml Coagulation 3.8% Sodium Citrate	3.6	13 x 75	9NC Sodium Citrate %3.8(0.129M)	4 months	Transparent	100/1200	●
434515	VACUSERA 4.5 ml Coagulation 3.8% Sodium Citrate	4.5	13 x 75	9NC Sodium Citrate %3.8(0.129M)	4 months	Transparent	100/1200	●
435515	VACUSERA 5 ml Coagulation 3.8% Sodium Citrate	5	13 x 100	9NC Sodium Citrate %3.8(0.129M)	4 months	Transparent	100/1200	●

*DT: Double Tube



VACUSERA CTAD TUBES

Vacusera CTAD Tubes are used for coagulation tests. Buffered Citrate Solution consists Theophylline Adenosine, Dipyridamole. CTAD Tubes are used for reliable test results by preventing activation of in vitro thrombocyte.

Reference Number	Description	Draw vol. (ml)	Size (mm)	Additive	Shelf life	Label Type	Pack /Carton	Cap Colour
234522	VACUSERA 1.8 ml CTAD - DT	1.8	13 x 75	Buffered Sodium Citrate 3.2% (0.109)	9 months	Paper	100/1200	●
234523	VACUSERA 2.7 ml CTAD - DT	2.7	13 x 75	Buffered Sodium Citrate 3.2% (0.109)	9 months	Paper	100/1200	●
234524	VACUSERA 3.6 ml CTAD	3.6	13 x 75	Buffered Sodium Citrate 3.2% (0.109)	4 months	Paper	100/1200	●
234525	VACUSERA 4.5 ml CTAD	4.5	13 x 75	Buffered Sodium Citrate 3.2% (0.109)	4 months	Paper	100/1200	●
434522	VACUSERA 1.8 ml CTAD - DT	1.8	13 x 75	Buffered Sodium Citrate 3.2% (0.109)	9 months	Transparent	100/1200	●
434523	VACUSERA 2.7 ml CTAD - DT	2.7	13 x 75	Buffered Sodium Citrate 3.2% (0.109)	9 months	Transparent	100/1200	●
434524	VACUSERA 3.6 ml CTAD	3.6	13 x 75	Buffered Sodium Citrate 3.2% (0.109)	4 months	Transparent	100/1200	●
434525	VACUSERA 4.5 ml CTAD	4.5	13 x 75	Buffered Sodium Citrate 3.2% (0.109)	4 months	Transparent	100/1200	●

DT: Double Tube



VACUSERA HEPARIN TUBES

Vacusera Heparin Tubes are coated with Lithium Heparin or Sodium Heparin to inhibit clotting. Sodium Heparin or Lithium Heparin Tubes are used for plasma determinations in clinical chemistry. Heparin Tubes are also available with gel separator.

VACUSERA LH LITHIUM HEPARIN TUBES

Reference Number	Description	Draw vol. (ml)	Size (mm)	Additive	Shelf life	Label Type	Pack /Carton	Cap Colour
234402	VACUSERA 2 ml LH/Lithium Heparin	2	13 x 75	LH/Lithium Heparin	18 months	Paper	100/1200	●
234404	VACUSERA 4 ml LH/Lithium Heparin	4	13 x 75	LH/Lithium Heparin	18 months	Paper	100/1200	●
235406	VACUSERA 6 ml LH/Lithium Heparin	6	13 x 100	LH/Lithium Heparin	18 months	Paper	100/1200	●
236409	VACUSERA 9 ml LH/Lithium Heparin	9	16 x 100	LH/Lithium Heparin	18 months	Paper	100/1200	●
434402	VACUSERA 2 ml LH/Lithium Heparin	2	13 x 75	LH/Lithium Heparin	18 months	Transparent	100/1200	●
434404	VACUSERA 4 ml LH/Lithium Heparin	4	13 x 75	LH/Lithium Heparin	18 months	Transparent	100/1200	●
435406	VACUSERA 6 ml LH/Lithium Heparin	6	13 x 100	LH/Lithium Heparin	18 months	Transparent	100/1200	●
436409	VACUSERA 9 ml LH/Lithium Heparin	9	16 x 100	LH/Lithium Heparin	18 months	Transparent	100/1200	●
234413	VACUSERA 3 ml LH/Lithium Heparin + GEL	3	13 x 75	GEL + LH/Lithium Heparin	18 months	Paper	100/1200	●
235415	VACUSERA 5 ml LH/Lithium Heparin + GEL	5	13 x 100	GEL + LH/Lithium Heparin	18 months	Paper	100/1200	●
236418	VACUSERA 8 ml LH/Lithium Heparin + GEL	8	16 x 100	GEL + LH/Lithium Heparin	18 months	Paper	100/1200	●
434413	VACUSERA 3 ml LH/Lithium Heparin + GEL	3	13 x 75	GEL + LH/Lithium Heparin	18 months	Transparent	100/1200	●
435415	VACUSERA 5 ml LH/Lithium Heparin + GEL	5	13 x 100	GEL + LH/Lithium Heparin	18 months	Transparent	100/1200	●
436418	VACUSERA 8 ml LH/Lithium Heparin + GEL	8	16 x 100	GEL + LH/Lithium Heparin	18 months	Transparent	100/1200	●



VACUSERA NH SODIUM HEPARIN TUBES

Vacusera Sodium Heparin Tubes are used for plasma determinations in clinical chemistry.

VACUSERA NH SODIUM HEPARIN

Reference Number	Description	Draw vol. (ml)	Size (mm)	Additive	Shelf life	Label Type	Pack /Carton	Cap Colour
234424	VACUSERA 4 ml NH/Sodium Heparin	4	13 x 75	NH/Sodium Heparin	18 months	Paper	100/1200	●
235426	VACUSERA 6 ml NH/Sodium Heparin	6	13 x 100	NH/Sodium Heparin	18 months	Paper	100/1200	●
236429	VACUSERA 9 ml NH/Sodium Heparin	9	16 x 100	NH/Sodium Heparin	18 months	Paper	100/1200	●
434424	VACUSERA 4 ml NH/Sodium Heparin	4	13 x 75	NH/Sodium Heparin	18 months	Transparent	100/1200	●
435426	VACUSERA 6 ml NH/Sodium Heparin	6	13 x 100	NH/Sodium Heparin	18 months	Transparent	100/1200	●
436429	VACUSERA 9 ml NH/Sodium Heparin	9	16 x 100	NH/Sodium Heparin	18 months	Transparent	100/1200	●
234433	VACUSERA 3 ml NH/Sodium Heparin + GEL	3	13 x 75	GEL + Sodium Heparin	18 months	Paper	100/1200	●
235435	VACUSERA 5 ml NH/Sodium Heparin + GEL	5	13 x 100	GEL + Sodium Heparin	18 months	Paper	100/1200	●
236438	VACUSERA 8 ml NH/Sodium Heparin + GEL	8	16 x 100	GEL + Sodium Heparin	18 months	Paper	100/1200	●
434433	VACUSERA 3 ml NH/Sodium Heparin + GEL	3	13 x 75	GEL + Sodium Heparin	18 months	Transparent	100/1200	●
435435	VACUSERA 5 ml NH/Sodium Heparin + GEL	5	13 x 100	GEL + Sodium Heparin	18 months	Transparent	100/1200	●
436438	VACUSERA 8 ml NH/Sodium Heparin + GEL	8	16 x 100	GEL + Sodium Heparin	18 months	Transparent	100/1200	●



VACUSERA NO ADDITIVE TUBES

VACUSERA no additive tubes are used in determinations for clinical chemistry and hormones, microbiological serology and immunology. VACUSERA no additive tubes do not contain any additive but are evacuated and the interior is sterile. They can be used as discard tubes or for the collection of blood.

Reference Number	Description	Draw vol. (ml)	Size (mm)	Additive	Shelf life	Label Type	Pack/Carton	Cap Colour
234102	VACUSERA 2 ml Z No Additive	2	13 x 75	No Additive	18 months	Paper	100/1200	○
234104	VACUSERA 4 ml Z No Additive	4	13 x 75	No Additive	18 months	Paper	100/1200	○
235106	VACUSERA 6 ml Z No Additive	6	13 x 100	No Additive	18 months	Paper	100/1200	○
236109	VACUSERA 9 ml Z No Additive	9	16 x 100	No Additive	18 months	Paper	100/1200	○
236100	VACUSERA 10 ml Z No Additive	10	16 x 100	No Additive	18 months	Paper	100/1200	○
434102	VACUSERA 2 ml Z No Additive	2	13 x 75	No Additive	18 months	Transparent	100/1200	○
434104	VACUSERA 4 ml Z No Additive	4	13 x 75	No Additive	18 months	Transparent	100/1200	○
435106	VACUSERA 6 ml Z No Additive	6	13 x 100	No Additive	18 months	Transparent	100/1200	○
436109	VACUSERA 9 ml Z No Additive	9	16 x 100	No Additive	18 months	Transparent	100/1200	○
436100	VACUSERA 10 ml Z No Additive	10	16 x 100	No Additive	18 months	Transparent	100/1200	○



VACUSERA ACD-A & ACD-B TUBES

Vacusera Blood Grouping Tubes contain 2 formulations as ACD-A & ACD-B solutions and are used in Blood Grouping.

Reference Number	Description	Draw vol. (ml)	Size (mm)	Additive	Shelf life	Label Type	Pack/Carton	Cap Colour
235726	VACUSERA 6 ML ACD-A	6	13 x 100	ACD-A	12 months	Paper	100/1200	●
236729	VACUSERA 9 ML ACD-A	9	16 x 100	ACD-A	12 months	Paper	100/1200	●
235736	VACUSERA 6 ML ACD-B	6	13 x 100	ACD-B	12 months	Paper	100/1200	●
236739	VACUSERA 9 ML ACD-B	9	16 x 100	ACD-B	12 months	Paper	100/1200	●
435726	VACUSERA 6 ML ACD-A	6	13 x 100	ACD-A	12 months	Transparent	100/1200	●
436729	VACUSERA 9 ML ACD-A	9	16 x 100	ACD-A	12 months	Transparent	100/1200	●
435736	VACUSERA 6 ML ACD-B	6	13 x 100	ACD-B	12 months	Transparent	100/1200	●
436739	VACUSERA 9 ML ACD-B	9	16 x 100	ACD-B	12 months	Transparent	100/1200	●



VACUSERA TRACE ELEMENT TUBES

Vacusera Trace Element tubes are used for determining the elements of Iron, Zinc, Copper, Mercury and Lead. Tubes consist Clot Activator, K2EDTA or Sodium Heparin.

Reference Number	Description	Draw vol. (ml)	Size (mm)	Additive	Shelf life	Label Type	Pack/Carton	Cap Colour
235006	VACUSERA 6 ml Trace Element CAT Serum Clot Activator	6	13 x 100	Clot Activator	18 months	Paper	100/1200	●
235016	VACUSERA 6 ml Trace Element NH/Sodium Heparin	6	13 x 100	Sodium Heparin	18 months	Paper	100/1200	●
235026	VACUSERA 6 ml Trace Element K2E/K2EDTA	6	13 x 100	K2EDTA	18 months	Paper	100/1200	●
435006	VACUSERA 6 ml Trace Element CAT Serum Clot Activator	6	13 x 100	Clot Activator	18 months	Transparent	100/1200	●
435016	VACUSERA 6 ml Trace Element NH/Sodium Heparin	6	13 x 100	Sodium Heparin	18 months	Transparent	100/1200	●
435026	VACUSERA 6 ml Trace Element K2E/K2EDTA	6	13 x 100	K2EDTA	18 months	Transparent	100/1200	●



VACUSERA CROSSMATCH TUBES

Vacusera Crossmatch tubes contain silica particles as clot activator and K2EDTA / K3EDTA as anticoagulant.

Reference Number	Description	Draw vol. (ml)	Size (mm)	Additive	Shelf life	Label Type	Pack/Carton	Cap Colour
235216	VACUSERA 6 ml Crossmatch CAT Serum Clot Activator	6	13 x 100	Clot Activator	18 months	Paper	100/1200	●
236219	VACUSERA 9 ml Crossmatch CAT Serum Clot Activator	9	16 x 100	Clot Activator	18 months	Paper	100/1200	●
234634	VACUSERA 4 ml Crossmatch K2E/K2EDTA	4	13 x 75	K2EDTA	18 months	Paper	100/1200	●
235636	VACUSERA 6 ml Crossmatch K2E/K2EDTA	6	13 x 100	K2EDTA	18 months	Paper	100/1200	●
234644	VACUSERA 4 ml Crossmatch K3E/K3EDTA	4	13 x 75	K3EDTA	18 months	Paper	100/1200	●
235646	VACUSERA 6 ml Crossmatch K3E/K3EDTA	6	13 x 100	K3EDTA	18 months	Paper	100/1200	●
435216	VACUSERA 6 ml Crossmatch CAT Serum Clot Activator	6	13 x 100	Clot Activator	18 months	Transparent	100/1200	●
436219	VACUSERA 9 ml Crossmatch CAT Serum Clot Activator	9	16 x 100	Clot Activator	18 months	Transparent	100/1200	●
434634	VACUSERA 4 ml Crossmatch K2E/K2EDTA	4	13 x 75	K2EDTA	18 months	Transparent	100/1200	●
435636	VACUSERA 6 ml Crossmatch K2E/K2EDTA	6	13 x 100	K2EDTA	18 months	Transparent	100/1200	●
434644	VACUSERA 4 ml Crossmatch K3E/K3EDTA	4	13 x 75	K3EDTA	18 months	Transparent	100/1200	●
435646	VACUSERA 6 ml Crossmatch K3E/K3EDTA	6	13 x 100	K3EDTA	18 months	Transparent	100/1200	●



VACUSERA GLUCOSE TUBES

Vacusera Glucose Tubes contain Sodium Fluoride and K3EDTA, Citric Acid, Potassium Oxalate, Na2 EDTA. Glucose tubes are used for glucose determinations like blood sugar, sugar tolerance, etanol and alcohol ratio in blood.

VACUSERA FE/SODIUM FLUORIDE + K3EDTA

Reference Number	Description	Draw vol. (ml)	Size (mm)	Additive	Shelf life	Label Type	Pack/Carton	Cap Colour
234702	VACUSERA 2 ml FE/Sodium Fluoride + K3EDTA	2	13 x 75	FE/Sodium Fluoride + K3EDTA	18 months	Paper	100/1200	●
234704	VACUSERA 4 ml FE/Sodium Fluoride + K3EDTA	4	13 x 75	FE/Sodium Fluoride + K3EDTA	18 months	Paper	100/1200	●
434702	VACUSERA 2 ml FE/Sodium Fluoride + K3EDTA	2	13 x 75	FE/Sodium Fluoride + K3EDTA	18 months	Transparent	100/1200	●
434704	VACUSERA 4 ml FE/Sodium Fluoride + K3EDTA	4	13 x 75	FE/Sodium Fluoride + K3EDTA	18 months	Transparent	100/1200	●

VACUSERA FX/SODIUM FLUORIDE + POTASSIUM OXALATE

Reference Number	Description	Draw vol. (ml)	Size (mm)	Additive	Shelf life	Label Type	Pack/Carton	Cap Colour
234712	VACUSERA 2 ml FX/Sodium Fluoride + Potassium Oxalate	2	13 x 75	FX/Sodium Fluoride + Potassium Oxalate	18 months	Paper	100/1200	●
234714	VACUSERA 4 ml FX/Sodium Fluoride + Potassium Oxalate	4	13 x 75	FX/Sodium Fluoride + Potassium Oxalate	18 months	Paper	100/1200	●
434712	VACUSERA 2 ml FX/Sodium Fluoride + Potassium Oxalate	2	13 x 75	FX/Sodium Fluoride + Potassium Oxalate	18 months	Transparent	100/1200	●
434714	VACUSERA 4 ml FX/Sodium Fluoride + Potassium Oxalate	4	13 x 75	FX/Sodium Fluoride + Potassium Oxalate	18 months	Transparent	100/1200	●

VACUSERA FE/SODIUM FLUORIDE+NA2 EDTA

Reference Number	Description	Draw vol. (ml)	Size (mm)	Additive	Shelf life	Label Type	Pack/Carton	Cap Colour
234722	VACUSERA 2 ml FE/Sodium Fluoride + NA2EDTA	2	13 x 75	FE/Sodium Fluoride + NA2EDTA	18 months	Paper	100/1200	●
234724	VACUSERA 4 ml FE/Sodium Fluoride + NA2EDTA	4	13 x 75	FE/Sodium Fluoride + NA2EDTA	18 months	Paper	100/1200	●
235725	VACUSERA 5 ml FE/Sodium Fluoride + NA2EDTA	5	13 x 100	FE/Sodium Fluoride + NA2EDTA	18 months	Paper	100/1200	●
434722	VACUSERA 2 ml FE/Sodium Fluoride + NA2EDTA	2	13 x 75	FE/Sodium Fluoride + NA2EDTA	18 months	Transparent	100/1200	●
434724	VACUSERA 4 ml FE/Sodium Fluoride + NA2EDTA	4	13 x 75	FE/Sodium Fluoride + NA2EDTA	18 months	Transparent	100/1200	●
435725	VACUSERA 5 ml FE/Sodium Fluoride + NA2EDTA	5	13 x 100	FE/Sodium Fluoride + NA2EDTA	18 months	Transparent	100/1200	●

VACUSERA FC/SODIUM FLUORIDE+CITRIC ACID

Reference Number	Description	Draw vol. (ml)	Size (mm)	Additive	Shelf life	Label Type	Pack/Carton	Cap Colour
234742	VACUSERA 2 ml FC Sodium Fluoride + Citric Acid	2	13 x 75	FC Sodium Fluoride + Citric Acid	18 months	Paper	100/1200	●
234742G	VACUSERA 2 ml FC Sodium Fluoride + Citric Acid	2	13 x 75	FC Sodium Fluoride + Citric Acid	18 months	Paper	100/1200	●
234743	VACUSERA 3 ml FC Sodium Fluoride + Citric Acid	3	13 x 75	FC Sodium Fluoride + Citric Acid	18 months	Paper	100/1200	●
234743G	VACUSERA 3 ml FC Sodium Fluoride + Citric Acid	3	13 x 75	FC Sodium Fluoride + Citric Acid	18 months	Paper	100/1200	●
234744	VACUSERA 4 ml FC Sodium Fluoride + Citric Acid	4	13 x 75	FC Sodium Fluoride + Citric Acid	18 months	Paper	100/1200	●
234744G	VACUSERA 4 ml FC Sodium Fluoride + Citric Acid	4	13 x 75	FC Sodium Fluoride + Citric Acid	18 months	Paper	100/1200	●
434742	VACUSERA 2 ml FC Sodium Fluoride + Citric Acid	2	13 x 75	FC Sodium Fluoride + Citric Acid	18 months	Transparent	100/1200	●
434742G	VACUSERA 2 ml FC Sodium Fluoride + Citric Acid	2	13 x 75	FC Sodium Fluoride + Citric Acid	18 months	Transparent	100/1200	●
434743	VACUSERA 3 ml FC Sodium Fluoride + Citric Acid	3	13 x 75	FC Sodium Fluoride + Citric Acid	18 months	Transparent	100/1200	●
434743G	VACUSERA 3 ml FC Sodium Fluoride + Citric Acid	3	13 x 75	FC Sodium Fluoride + Citric Acid	18 months	Transparent	100/1200	●
434744	VACUSERA 4 ml FC Sodium Fluoride + Citric Acid	4	13 x 75	FC Sodium Fluoride + Citric Acid	18 months	Transparent	100/1200	●
434744G	VACUSERA 4 ml FC Sodium Fluoride + Citric Acid	4	13 x 75	FC Sodium Fluoride + Citric Acid	18 months	Transparent	100/1200	●

VACUSERA BLOOD COLLECTION NEEDLES





Vacusera Blood Collection Needles are used in blood collection, single-used and sterile. The needles are coated with silicone, a low friction and ensuring very soft vein entry.

The colour of needle hub identifies needle gauge.

Vacusera Blood Collection Needles are also available with integrated safety cap and window (Vision).



VACUSERA BLOOD COLLECTION NEEDLES

Reference Number	Description	Size	Pack/Carton	Colour
250018K	Blood Collection Needle 18 G	18 G x 1 1/2" (1.2x38mm)	100/5000	
250018KW	Blood Collection Needle 18 G	18 G x 1 1/2" (1.2x38mm)	100/5000	
250020K	Blood Collection Needle 20 G	20 G x 1 1/2" (0.9x38mm)	100/5000	
250020KW	Blood Collection Needle 20 G	20 G x 1 1/2" (0.9x38mm)	100/5000	
250021K	Blood Collection Needle 21 G	21 G x 1 1/2" (0.8x38mm)	100/5000	
250021KW	Blood Collection Needle 21 G	21 G x 1 1/2" (0.8x38mm)	100/5000	
250022K	Blood Collection Needle 22 G	22 G x 1 1/2" (0.7x38mm)	100/5000	
250022KW	Blood Collection Needle 22 G	22 G x 1 1/2" (0.7x38mm)	100/5000	
250023K	Blood Collection Needle 23 G	23 G x 1 1/2" (0,6x38mm)	100/5000	
250023KW	Blood Collection Needle 23 G	23 G x 1 1/2" (0,6x38mm)	100/5000	
253018K	Blood Collection Needle 18 G	18 G x 1" (1,2x25mm)	100/5000	
253018KW	Blood Collection Needle 18 G	18 G x 1" (1,2x25mm)	100/5000	
253020K	Blood Collection Needle 20 G	20 G x 1" (0,9x25mm)	100/5000	
253020KW	Blood Collection Needle 20 G	20 G x 1" (0,9x25mm)	100/5000	
253021K	Blood Collection Needle 21 G	21 G x 1" (0.8x25mm)	100/5000	
253021KW	Blood Collection Needle 21 G	21 G x 1" (0.8x25mm)	100/5000	
253022K	Blood Collection Needle 22 G	22 G x 1" (0.7x25mm)	100/5000	
253022KW	Blood Collection Needle 22 G	22 G x 1" (0.7x25mm)	100/5000	
253023K	Blood Collection Needle 23 G	23 G x 1" (0,6x25mm)	100/5000	
253023KW	Blood Collection Needle 23 G	23 G x 1" (0,6x25mm)	100/5000	
255020K	Blood Collection Needle 20 G - VISION	20 G x 1 1/2" (0.9x38mm)	100/5000	
255021K	Blood Collection Needle 21 G - VISION	21 G x 1 1/2" (0.8x38mm)	100/5000	
255022K	Blood Collection Needle 22 G - VISION	22 G x 1 1/2" (0.7x38mm)	100/5000	
255023K	Blood Collection Needle 23 G - VISION	23 G x 1" (0,6x25mm)	100/5000	
261021K	Needle Vision + Safety Holder 21 G	21 G x 1 1/2" (0.8x38mm)	24/192	
261022K	Needle Vision + Safety Holder 22 G	22 G x 1 1/2" (0.7x38mm)	24/192	
251021K	Integrated Safety Needle 21 G	21 G x 1 1/4" (0.8x32mm)	48/2400	
251021KW	Integrated Safety Needle 21 G	21 G x 1 1/4" (0.8x32mm)	48/2400	
251022K	Integrated Safety Needle 22 G	22 G x 1 1/4" (0.7x32mm)	48/2400	
251022KW	Integrated Safety Needle 22 G	22 G x 1 1/4" (0.7x32mm)	48/2400	
252020	Luer Adapter 20 G	20 G	100/5000	

VACUSERA ACCESSORIES

Vacusera Accessories provide necessary products for blood collection.



BLOOD COLLECTION SETS WITH SAFETY SHIELD

Vacusera Safety Blood Collection Sets are used for blood collection from difficult veins like children and elder people. Safety mechanism protects healthcare workers from needle stick injury.

Reference Number	Description	Size	Pack/Carton	Colour
24121190K	Blood Collection Set with Safety Shield 21 G 3/4" x 7"	0.8 x 19mm x 180mm	100/2000	●
24121300K	Blood Collection Set with Safety Shield 21 G 3/4" x 12"	0.8 x 19mm x 305mm	100/2000	●
24122190K	Blood Collection Set with Safety Shield 22 G 3/4" x 7"	0.7 x 19mm x 180mm	100/2000	●
24122300K	Blood Collection Set with Safety Shield 22 G 3/4" x 12"	0.7 x 19mm x 305mm	100/2000	●
24123190K	Blood Collection Set with Safety Shield 23 G 3/4" x 7"	0.6 x 19mm x 180mm	100/2000	●
24123300K	Blood Collection Set with Safety Shield 23 G 3/4" x 12"	0.6 x 19mm x 305mm	100/2000	●
24125190K	Blood Collection Set with Safety Shield 25 G 3/4" x 7"	0.5 x 19mm x 180mm	100/2000	●
24125300K	Blood Collection Set with Safety Shield 25 G 3/4" x 12"	0.5 x 19mm x 305mm	100/2000	●
24121190G	Blood Collection Set with Safety Shield 21 G 3/4" x 7.5"	0.8 x 20mm x 190mm	100/900	●
24121300G	Blood Collection Set with Safety Shield 21 G 3/4" x 12"	0.8 x 20mm x 300mm	100/900	●
24123190G	Blood Collection Set with Safety Shield 23 G 3/4" x 7.5"	0.6 x 20mm x 190mm	100/900	●
24123300G	Blood Collection Set with Safety Shield 23 G 3/4" x 12"	0.6 x 20mm x 300mm	100/900	●
24125190G	Blood Collection Set with Safety Shield 25 G 3/4" x 7.5"	0.5 x 20mm x 190mm	100/900	●
24125300G	Blood Collection Set with Safety Shield 25 G 3/4" x 12"	0.5 x 20mm x 300mm	100/900	●
24321190K	Vacusera Safe Plus® Safety Blood Collection Set 21G 3/4" x 7"	0.8 x 19mm x 178mm	50/1000	●
24321300K	Vacusera Safe Plus® Safety Blood Collection Set 21 G 3/4" x 12"	0.8 x 19mm x 305mm	50/1000	●
24323190K	Vacusera Safe Plus® Safety Blood Collection Set 23 G 3/4" x 7"	0.6 x 19mm x 178mm	50/1000	●
24323300K	Vacusera Safe Plus® Safety Blood Collection Set 23 G 3/4" x 12"	0.6 x 19mm x 305mm	50/1000	●
24325190K	Vacusera Safe Plus® Safety Blood Collection Set 25 G 3/4" x 7"	0.5 x 19mm x 178mm	50/1000	●
24325300K	Vacusera Safe Plus® Safety Blood Collection Set 25 G 3/4" x 12"	0.5 x 19mm x 305mm	50/1000	●



BLOOD COLLECTION SETS WITH SAFETY SHIELD + HOLDER

Vacusera Safety Blood Collection Sets are also available with Pre-Attached holder.

Reference Number	Description	Size	Pack/Carton	Colour
24221190K	Blood Collection Set with Safety Shield + Holder 21 G 3/4" x 7"	0.8 x 19mm x 180mm	25/500	●
24221300K	Blood Collection Set with Safety Shield + Holder 21 G 3/4" x 12"	0.8 x 19mm x 305mm	25/500	●
24222190K	Blood Collection Set with Safety Shield + Holder 22 G 3/4" x 7"	0.7 x 19mm x 180mm	25/500	●
24222300K	Blood Collection Set with Safety Shield + Holder 22 G 3/4" x 12"	0.7 x 19mm x 305mm	25/500	●
24223190K	Blood Collection Set with Safety Shield + Holder 23 G 3/4" x 7"	0.6 x 19mm x 180mm	25/500	●
24223300K	Blood Collection Set with Safety Shield + Holder 23 G 3/4" x 12"	0.6 x 19mm x 305mm	25/500	●
24225190K	Blood Collection Set with Safety Shield + Holder 25 G 3/4" x 7"	0.5 x 19mm x 180mm	25/500	●
24225300K	Blood Collection Set with Safety Shield + Holder 25 G 3/4" x 12"	0.5 x 19mm x 305mm	25/500	●
24221190G	Blood Collection Set with Safety Shield + Holder 21 G 3/4" x 7,5"	0.8 x 20mm x 190mm	50/400	●
24221300G	Blood Collection Set with Safety Shield + Holder 21 G 3/4" x 12"	0.8 x 20mm x 300mm	50/400	●
24223190G	Blood Collection Set with Safety Shield + Holder 23 G 3/4" x 7,5"	0.6 x 20mm x 190mm	50/400	●
24223300G	Blood Collection Set with Safety Shield + Holder 23 G 3/4" x 12"	0.6 x 20mm x 300mm	50/400	●
24225190G	Blood Collection Set with Safety Shield + Holder 25 G 3/4" x 7,5"	0.5 x 20mm x 190mm	50/400	●
24225300G	Blood Collection Set with Safety Shield + Holder 25 G 3/4" x 12"	0.5 x 20mm x 300mm	50/400	●
24421190K	Vacusera Safe Plus® Safety Blood Collection Set + Holder 21 G 3/4" x 7"	0.8 x 19mm x 178mm	50/1000	●
24421300K	Vacusera Safe Plus® Safety Blood Collection Set + Holder 21 G 3/4" x 12"	0.8 x 19mm x 305mm	50/1000	●
24423190K	Vacusera Safe Plus® Safety Blood Collection Set + Holder 23 G 3/4" x 7"	0.6 x 19mm x 178mm	50/1000	●
24423300K	Vacusera Safe Plus® Safety Blood Collection Set + Holder 23 G 3/4" x 12"	0.6 x 19mm x 305mm	50/1000	●
24425190K	Vacusera Safe Plus® Safety Blood Collection Set + Holder 25 G 3/4" x 7"	0.5 x 19mm x 178mm	50/1000	●
24425300K	Vacusera Safe Plus® Safety Blood Collection Set + Holder 25 G 3/4" x 12"	0.5 x 19mm x 305mm	50/1000	●



BLOOD COLLECTION NEEDLES + SAFETY HOLDER



Reference Number	Description	Pack/Carton
260018K	Blood Collection Needle + Safety Holder 18 G x 1 1/2" (1.2x38mm)	25/500
260020K	Blood Collection Needle + Safety Holder 20 G x 1 1/2" (0.9x38mm)	25/500
260021K	Blood Collection Needle + Safety Holder 21 G x 1 1/2" (0.8x38mm)	25/500
260022K	Blood Collection Needle + Safety Holder 22 G x 1 1/2" (0.7x38mm)	25/500
260023K	Blood Collection Needle + Safety Holder 23 G x 1 1/2" (0.6x38mm)	25/500

HOLDERS

Vacusera Holders are compatible with Vacusera Blood Collection Needles and Vacusera Blood Collection Tubes. It provides safety and easy use for healthcare workers.



Reference Number	Description	Pack/Carton
260001	Tube Holder - Standard	200/1000
260002	Tube Holder with Safety Shield	200/800
260003	Tube Holder - Automatic	100/1500
260004	Blood Collection Holder with Female Luer Lock	200/800
260005	Blood Collection Holder with Male Luer Lock	200/800
260006K	Luer Adapter + Standard Holder	200/800

VACUSERA TOURNIQUET

Vacusera Tourniquet is used for tying the vein during blood collection. It is safe and easy to use.



Reference Number	Description	Quantity/Box
259001	Automatic Tourniquet	50 pcs / box
259001-1	Automatic Tourniquet for children - Green	50 pcs / box
259001-2	Automatic Tourniquet for children - Pink	50 pcs / box
259050	Disposable Tourniquet	50 pcs / box

VACUSERA SHARPS DISPOSAL CONTAINER

For disposal of used sharp objects like cannulas, scalpels, needles, holders, syringes etc. Available in 2.1 lt. and 7.5 lt.



Reference Number	Description	Quantity/Box
101175	Sharps Disposal Container 7.5 lt.	40 pcs / box
101121	Sharps Disposal Container 2.1 lt.	100 pcs / box

VACUSERA MINI CAPILLARY BLOOD COLLECTION SYSTEM

Vacusera Mini Capillary Blood Collection System provides all the necessary products for pediatric need.

VACUSERA MINI CAPILLARY BLOOD COLLECTION TUBES

Vacusera Mini Capillary Blood Collection Tubes offer maximum comfort to healthcare professionals with their specially designed cap that ensures ease of use in pediatric blood collection.

VACUSERA MINI SERUM TUBES



Reference Number	Description	Draw vol. (ml)	Additive	Pack /Carton	Cap Colour
238202	VACUSERA MINI 0.2 ml CAT Serum Clot Activator	0.2	Clot Activator	50/1000	●
238205	VACUSERA MINI 0.5 ml CAT Serum Clot Activator	0.5	Clot Activator	50/1000	●
238302	VACUSERA MINI 0.2 ml CAT Serum GEL + Clot Activator	0.2	GEL + Clot Activator	50/1000	●
238305	VACUSERA MINI 0.5 ml CAT Serum GEL + Clot Activator	0.5	GEL + Clot Activator	50/1000	●
238235	VACUSERA MINI CAT Serum Clot Activator 0,5ml (13x75mm)	0.5	Clot Activator	100/1000	●
238335	VACUSERA MINI CAT Serum Gel & Clot Activator 0,5ml (13x75mm)	0.5	GEL + Clot Activator	100/1000	●

VACUSERA MINI EDTA TUBES



Reference Number	Description	Draw vol. (ml)	Additive	Pack /Carton	Cap Colour
238602	VACUSERA MINI 0.2 ml K2E/K2EDTA	0.2	K2E K2EDTA	50/1000	●
238605	VACUSERA MINI 0.5 ml K2E/K2EDTA	0.5	K2E K2EDTA	50/1000	●
238612	VACUSERA MINI 0.2 ml K3E/K3EDTA	0.2	K3E K3EDTA	50/1000	●
238615	VACUSERA MINI 0.5 ml K3E/K3EDTA	0.5	K3E K3EDTA	50/1000	●
238625	VACUSERA MINI 0.5 ml K2E/K2EDTA (13x75mm)	0.5	K2E K2EDTA	100/1000	●
238635	VACUSERA MINI 0.5 ml K2E/K2EDTA (13x75mm)	0.5	K2E K2EDTA	100/1000	●

VACUSERA MINI HEPARIN TUBES



Reference Number	Description	Draw vol. (ml)	Additive	Pack /Carton	Cap Colour
238402	VACUSERA MINI 0.2 ml LH/Lithium Heparin	0.2	LH/Lithium Heparin	50/1000	●
238405	VACUSERA MINI 0.5 ml LH/Lithium Heparin	0.5	LH/Lithium Heparin	50/1000	●
238412	VACUSERA MINI 0.2 ml LH/Lithium Heparin + GEL	0.2	LH/Lithium Heparin+GEL	50/1000	●
238415	VACUSERA MINI 0.5 ml LH/Lithium Heparin + GEL	0.5	LH/Lithium Heparin + GEL	50/1000	●
238422	VACUSERA MINI 0.2 ml NH/Sodium Heparin	0.2	NH/Sodium Heparin	50/1000	●
238425	VACUSERA MINI 0.5 ml NH/Sodium Heparin	0.5	NH/Sodium Heparin	50/1000	●
238435	VACUSERA MINI LH/Lithium Heparin 0,5 ml (13x75mm)	0.5	LH/Lithium Heparin	100/1000	●



VACUSERA SEDIMENTATION SYSTEMS

Vacusera Sedimentation Tubes are consisting 3.2% sodium citrate for ESR test.

VACUSERA CLOSED SEDIMENTATION SYSTEM

Reference Number	Description	Draw vol. (ml)	Size (mm)	Additive	Shelf life	Label Type	Pack/ Carton	Cap Colour
233903	VACUSERA 1.28 ml Glass ESR Tube	1.28	8 x 120	4NC Sodium Citrate 3.2%	24 months	Paper	100/1000	●
233902	VACUSERA 1.6 ml Glass ESR Tube	1.6	9 x 120	4NC Sodium Citrate 3.2%	24 months	Paper	100/1000	●
290020	VACUSERA 20 ESR analyzer						1/1	
290100	VACUSERA 100 ESR analyzer						1/1	
233901	VACUSERA 1.28 ml & 1.6 ml ESR Rack						1/10	

VACUSERA OPEN SEDIMENTATION SYSTEM

Reference Number	Description	Draw vol. (ml)	Size (mm)	Additive	Shelf life	Label Type	Pack/ Carton	Cap Colour
234902	VACUSERA 2 ml ESR Tube	2	13 x 75	4NC Sodium Citrate 3.2%	12 months	Paper	100/1200	●
234900	VACUSERA Disposable ESR Pipette				60 months		200/2000	
234901	VACUSERA ESR RACK without graduation for 234902 & 434902 (Vacusera Open Sedimentation System)						1/25	



VACUSERA URINE COLLECTION SYSTEMS

Vacusera Urine Collection Systems provide easy and comfortable use with urine tubes and integrated urine beaker for healthcare workers.

Reference Number	Description	Draw vol. (ml)	Size (mm)	Additive	Shelf life	Label Type	Pack/Carton	Cap Colour
234814	VACUSERA 4 ml Urine Tube - Boric Acid	4	13 x 75	Boric Acid	18 months	Paper	100/1200	●
235806	VACUSERA 6 ml Urine Tube - No Additive	6	13 x 100	No Additive	18 months	Paper	100/1200	●
236808	VACUSERA 8 ml Urine Tube - No Additive	8	16 x 100	No Additive	18 months	Paper	100/1200	●
236800	VACUSERA 10 ml Urine Tube - No Additive	10	16 x 100	No Additive	18 months	Paper	100/1200	●
235816	VACUSERA 6 ml Urine Tube - Boric Acid	6	13 x 100	Boric Acid	18 months	Paper	100/1200	●
236810	VACUSERA 10 ml Urine Tube - Boric Acid	10	16 x 100	Boric Acid	18 months	Paper	100/1200	●
236828	VACUSERA 8 ml Urine Tube - Chlorhexidine	8	16 x 100	Chlorhexidine	18 months	Paper	100/1200	●
236820	VACUSERA 10 ml Urine Tube - Chlorhexidine	10	16 x 100	Chlorhexidine	18 months	Paper	100/1200	●
434814	VACUSERA 4 ml Urine Tube - Boric Acid	4	13 x 75	Boric Acid	18 months	Transparent	100/1200	●
435806	VACUSERA 6 ml Urine Tube - No Additive	6	13 x 100	No Additive	18 months	Transparent	100/1200	●
436808	VACUSERA 8 ml Urine Tube - No Additive	8	16 x 100	No Additive	18 months	Transparent	100/1200	●
436800	VACUSERA 10 ml Urine Tube - No Additive	10	16 x 100	No Additive	18 months	Transparent	100/1200	●
435816	VACUSERA 6 ml Urine Tube - Boric Acid	6	13 x 100	Boric Acid	18 months	Transparent	100/1200	●
436810	VACUSERA 10 ml Urine Tube - Boric Acid	10	16 x 100	Boric Acid	18 months	Transparent	100/1200	●
436828	VACUSERA 8 ml Urine Tube - Chlorhexidine	8	16 x 100	Chlorhexidine	18 months	Transparent	100/1200	●
436820	VACUSERA 10 ml Urine Tube - Chlorhexidine	10	16 x 100	Chlorhexidine	18 months	Transparent	100/1200	●
103023	VACUSERA Urine Beaker with Integrated Holder 100 ml (Nonsterile)	100		No Additive	36 months		300	●
103026	VACUSERA Urine Beaker with Integrated Holder 100 ml in a single bag (Sterile)	100		No Additive	36 months		300	●
103033	VACUSERA 24 Hourly Integrated Urine Collection Cap 3L	3000			60 months		14	●
236839	VACUSERA 9 ml Urine Tube – No Additive – Conical Bottom	9	16 x 100	No Additive	18 months	Paper	100/1200	●
236848	VACUSERA 8 ml Urine Tube – Boric Acid – Conical Bottom	8	16 x 100	Boric Acid	18 months	Paper	100/1200	●
236859	VACUSERA 9 ml Urine Tube – Chlorhexidine – Conical Bottom	9	16 x 100	Chlorhexidine	18 months	Paper	100/1200	●

VACUSERA BLOOD COLLECTION SYSTEMS ORDER OF DRAW



DRAW VOL	COLOR CODE	TUBE TYPE	DESCRIPTION	MIXING	CENTRIFUGE SPEED & TIME
1 ml / 1.8 ml / 2.7 ml / 3.6 ml / 4.5 ml / 5ml		Sodium Citrate	Coagulation Tests	3-4	PRP: 150 g (RCF), 5 min PPP: 1500–2000 g (RCF), 10 min PPF: 2500–3000 g (RCF), 20 min
1 ml / 2 ml / 3 ml / 4 ml / 6 ml / 9 ml / 10 ml		Clot Activator	Biochemistry, Hormone Tests, TDM and Serology Tests	5-6	1800 g - 2200 g (RCF) 10-15 min
2 ml / 2.5 ml / 3.5 ml / 4 ml / 5 ml / 8 ml / 9 ml		Clot Activator + GEL	Biochemistry, Hormone Tests, TDM and Serology Tests	5-6	1800 g - 2200 g (RCF) 10-15 min
2 ml / 4 ml / 6 ml / 9 ml		Heparin	Biochemistry, Routine Clinical Chemistry Tests	8-10	1800 g - 2200 g (RCF) 10-15 min
3 ml / 5 ml / 8 ml		Heparin + GEL	Biochemistry, Routine Clinical Chemistry Tests	8-10	1800 g - 2200 g (RCF) 10-15 min
1 ml / 2 ml / 3 ml / 4 ml / 4.5 ml / 6 ml / 9 ml		EDTA	Hematology, Blood Grouping, Hemogram, Peripheral Smear Tests	8-10	
3 ml / 5 ml / 8 ml		EDTA + GEL	Molecular Diagnostic Tests	8-10	1800 g - 2200 g (RCF) 10-15 min
2 ml / 4 ml		Sodium Fluoride + K3EDTA	Glucose, Alcohol Tests	8-10	1300 g-2200 g (RCF) 10-15 min
2 ml / 4 ml / 5 ml		Sodium Fluoride + Na2EDTA	Glucose, Alcohol Tests	8-10	1300 g-2200 g (RCF) 10-15 min
2 ml / 4 ml		Sodium Fluoride + Potassium Oxalate	Glucose, Alcohol Tests	8-10	1300 g-2200 g (RCF) 10-15 min
2 ml / 3 ml / 4 ml		Sodium Fluoride + Citric Acid	Glucose, Alcohol Tests	15-20	1300 g-2200 g (RCF) 10-15 min
1.28 ml / 1.6 ml / 2ml		ESR	Sedimentation Tests	3-4	
6 ml / 9 ml		Cross Match Clot Activator	Crossmatch Tests	5-6	1800 g - 2200 g (RCF) 10-15 min
4 ml / 6 ml		Cross Match EDTA	Crossmatch Tests	8-10	
6 ml / 9 ml		ACD-A & ACD-B	Blood Grouping Tests	8-10	
6 ml		Trace Element Clot Activator	Trace Element Tests (Zinc, Copper, Lead, Mercury, etc.)	5-6	1800 g - 2200 g (RCF) 10-15 min
6 ml		Trace Element Sodium Heparin	Trace Element Tests (Zinc, Copper, Lead, Mercury, etc.)	8-10	1800 g - 2200 g (RCF) 10-15 min
6 ml		Trace Element EDTA	Trace Element Tests (Zinc, Copper, Lead, Mercury, etc.)	8-10	
5 ml		Clot Activator (Thrombin) + GEL	Biochemistry and Hormone Tests	5-6	1800 g - 2200 g (RCF) 10-15 min 3000 g (RCF), 5-10 min

Insufficient blood volume and mixing properly can effect the test results and may cause re-collection of blood.

* With fixed-angle rotors 15 minutes - With swing-out rotors 10 minutes

VACUSERA



www.disera.com.tr

disera
RESULTS OF THE SCIENTIFIC PROCESS

Disera Tıbbi Malzeme Lojistik Sanayi ve Ticaret A.Ş.

Head Office: 5758 Sok. No:4 H/11 P.K. 35110 / Karabağlar - İZMİR / TÜRKİYE

Factory 1: İbni Melek O.S.B Mah. Tosbi Yol 5 Sk. No: 46 Tire - İZMİR / TÜRKİYE

Factory 2: İbni Melek O.S.B Mah. Tosbi Yol 1. Sk. No: 1/1, Tire - İZMİR / TÜRKİYE

Factory 3: İbni Melek O.S.B Mah. Tosbi Yol 5. Sk. No:32/A Tire - İZMİR / TÜRKİYE

Phone: +90 (232) 264 66 68 Fax: +90 (232) 264 84 00

www.disera.com.tr - www.vacusera.com